

Sounding Cock Self Closing Type

Bronze

Cast Iron Lever

360° Turning Lever

Technical features

Standard	DIN 86120 Form A-with test valve
Face to face	DIN 86120
Threaded End	BSP-female acc. to DIN EN 10226-1 (DIN 2999)

- Bronze self-closing sounding cocks with BSP-female threaded end and 360° turning lever. Standard equipped with a brass self-closing test valve, cap and chain.

- Application: To be used for tank sounding.



Pressure & temperature ranges

Bore	Pressure rating	Working pressure [bar]		Hydro test pressure [bar]	
		90 °C	Casing	Closure	
DN 32- DN 65	PN2.5	2.5	4	2.8	

Material specifications

Part No.	Component	Material		
	B o d y	CuSn5Zn5Pb5-C	CC491K	RG5
2	Bonnet	CuSn5Zn5Pb5-C	CC491K	RG5
3	Plunger	CuSn5Zn5Pb5-C	CC491K	RG5
4	Cap	CuSn5Zn5Pb5-C	CC491K	RG5
5	Test valve	CuZn39Pb3	CW614N	Ms58
6	Lever	EN-GJL250	EN-JL 1040	GG25

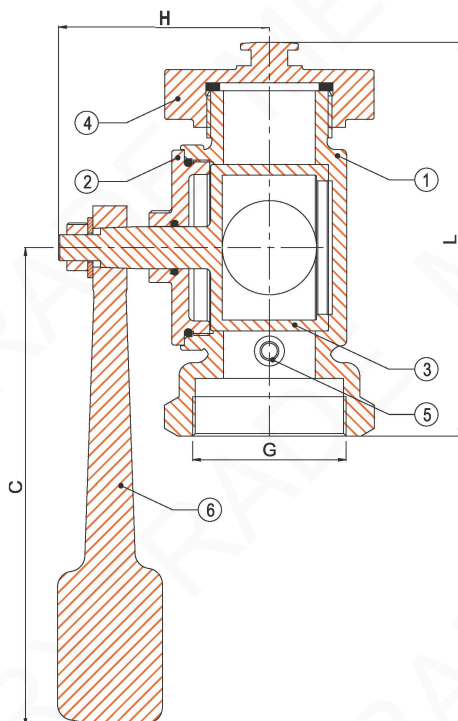

Dimensions

DN	G	L	C	H	Weight
[mm]	["]	[mm]	[mm]	[mm]	[kg]
32	1¼	150	185	75	4.3
40	1½	150	185	75	4.0
50	2	150	185	75	4.0
65	2½	150	185	75	4.0